

JAMESWAY®

MAX^XTRAC
DURATECH





ENGINEERED FOR PROFESSIONAL HAULERS



With 11 models from 4,000 to 10,200 gallons, you can choose the perfect match for your tractors and your conditions.

It's all about getting the job done fast. Large farms and custom haulers are always working against the clock so Jamesway MAXX-TRAC spreader tanks deliver maximum performance and minimum downtime.



MAXX WORKDAYS

The weather doesn't always cooperate but MAXX-TRAC tankers keep running when others are parked. The tandem, triple and quad-axle trailers operate at low load per axle even on the biggest models.



MAXX PRODUCTIVITY

Less time spent travelling means more loads per day. MAXX-TRAC's high speed steering system and impressive off-road manoeuvrability make getting to the field safer and faster.



MAXX PERFORMANCE

MAXX-TRAC spreader tanks are equipped with Jamesway's new High-Output Series impellers so you can unload in record time. The proven oilbath bearing chamber delivers maximum reliability. Choose 6" or 8" discharge system.

PARALLEL LINK SUSPENSION



DURA-TECH SUSPENSION

All the twists and turns found in the “off-road” world of manure spreading are converted to simple vertical movements. The left and right sides move independently, keeping equal load on all wheels at all times.

Each side works completely independently. The 16” stroke handles big obstacles with ease.

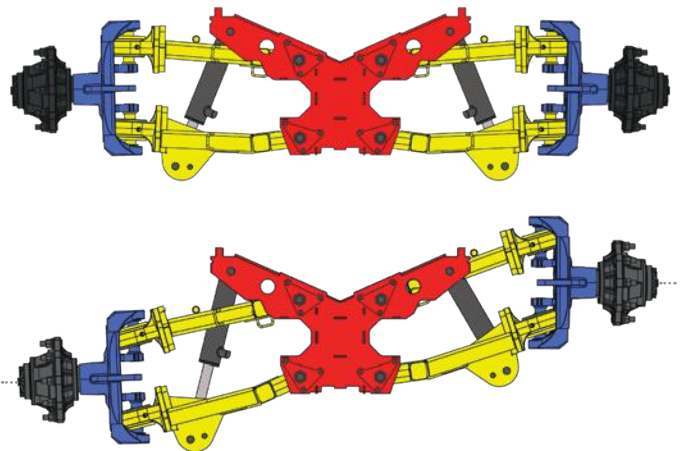

FULL-FRAME TRAILER

The rugged MAXX-TRAC trailer glides smoothly over rough ground and through corners. The smooth hydraulic suspension cushions shock loads and the responsive steering system really takes the load off your tractor during cornering.

MAXX-TRAC is built for large injection systems. The full-frame independent trailer carries the towing load while the tank just rides above it all. The tank position is adjustable to guarantee proper balance and drawbar loading even when carrying heavy injectors at the rear, delivering maximum traction and smooth handling every time.



PERFORMANCE IN THE FIELD IS ONLY HALF THE STORY.... FIRST YOU HAVE TO GET THERE.



Hauling heavy tankers is a challenge on today's busy roads.
Jamesway's MAXX-TRAC spreader tanks are designed with safety in mind:



HIGH-POWER AUTOMATIC BRAKING

Heavy loads need powerful brakes. All Jamesway tankers feature the largest, strongest brakes in the business and are ready to work with any tractor Auto-Braking system.



STAY IN YOUR OWN LANE

MAXX-TRAC's narrow profile keeps you out of the oncoming lane and gives better visibility to vehicles following the tanker.



HIGH-SPEED AUTOMATIC STEERING

Roads aren't straight. Jamesway's automatic steering works at any speed to let the tanker gently follow the tractor. Minimizing "jackknife" force through curves and corners keeps you in control in wet or slippery conditions.



MAXIMUM VISIBILITY

LED signal lights and reflective side bands are standard on all MAXX-TRAC tankers. Optional strobe flashers and DOT-approved reflective banding improve night time visibility.

MAXX-TRAC steering means less stress on you and your equipment.



Fully automatic steering operates at any speed

ARE YOU STEERING OR SMEARING?

Reduced field damage is just one of the advantages to steering tankers. MAXX-TRAC's responsive steering system lets the tanker gently follow around corners with much less strain on axles, hubs, rims and tires compared to non-steer tankers resulting in less wear & tear on your tanker and on your tractor.



Dragging non-steerable tankers around corners is tough on your equipment and on your land.

Simple construction,
easy to maintain.

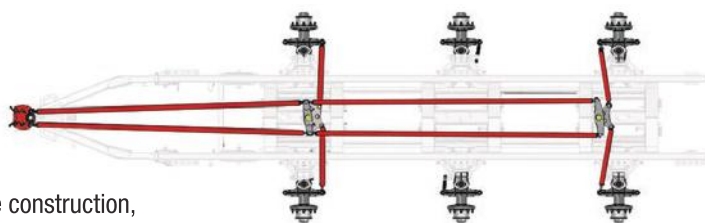

MAXX-TRAC INDUSTRIAL BRAKES HAVE PLENTY OF STOPPING POWER FOR THE BIGGEST LOADS.

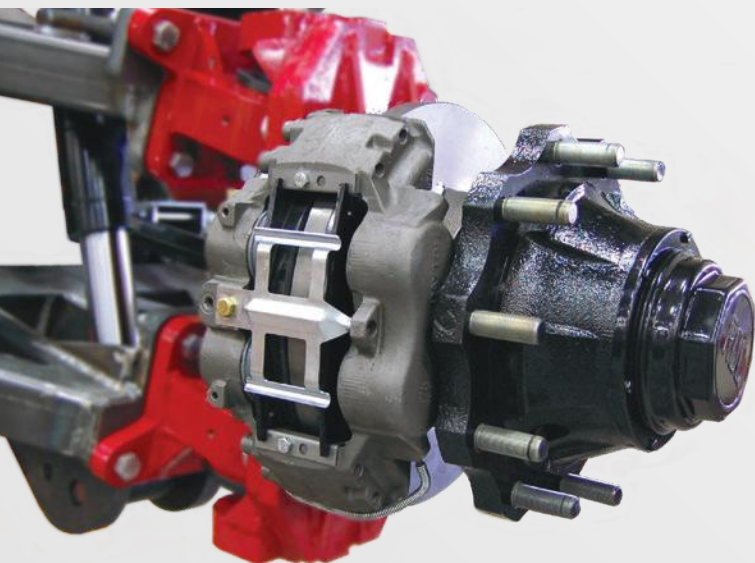

With so many vehicles on the road today, you must always expect the unexpected. Jamesway's massive 4-piston brake calipers provide far larger brake pads than the industry standard. Automatic braking makes road travel safer by reducing operator errors. Simply plug into the tractor braking port for fully automatic pedal braking. Brakes may also be operated manually via the standard tractor remote ports.



AIR BRAKE OPTION

The optional air brake system is designed for tractors equipped with air brake trailer connection. Jamesway's air operated disc brakes provide far greater reliability than competitive drum brakes.

MODULAR CONSTRUCTION

Regular maintenance protects your investment.

MAXX-TRAC tankers are designed for fast and easy service so you can spend your time in the field. Each module is removable using standard on-farm tools. Front or rear wheel, left or right side: it makes no difference....all modules are identical at every wheel on every Maxx-Trac.

MAXX DURABILITY

Built for heavy sand loads.

The Dura-Tech industrial-series hub & axle assembly is unique to Jamesway. The outer wheel bearings are the same size as the inner bearings, and the non-tapered high-strength axles are designed specifically for use with extra-wide flotation tires.



20,000 lb Dura-Tech hubs



Oil-filled hubs option shown



Dura-Tech hubs feature shaft-mounted seals for superior protection and durability.

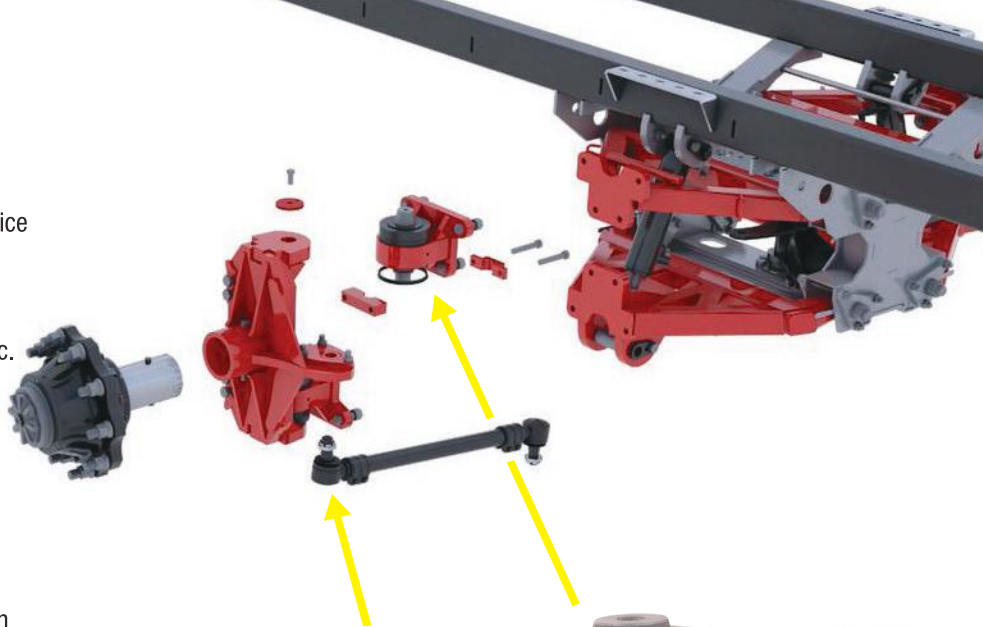

ULTRA-LOW MAINTENANCE

Spend less time greasing. Extreme-duty tie rods are built for the big jobs. The sealed 3-1/4" ball joint assembly needs no grease.

Sealed swivel modules eliminate kingpins and bushings in the wheel suspension. The modules require much less grease and provide much longer service life.

HYDRAULIC SUSPENSION



The smooth riding hydraulic suspension system maintains an equal load on each wheel at all times.

Double-ported cylinders and oil-filled breather hoses are standard equipment to ensure maximum durability and long life.



Weight-Transfer option

This hydraulic control lifts the front axle to apply additional weight on the tractor drawbar when needed to provide traction. Recommended for hilly areas.

ACCESSORIES & OPTIONS



REAR DISCHARGE CHOICES

- High spray discharge
- Low spray discharge
- High & Low spray discharge
- Double spray kit (left/right)
- Splash plates (3.75", 5" or 6")



TOP PIPE CHOICES

- 6" or 8" diameter
- Anti-siphon pipe
- Flow control valve
- In-tank agitation kit
- Ready-for-flowmeter kit



IMPELLER CHOICES

- Hardox-450™ AR steel option
- 540 or 1000 PTO drive
- Hydraulic drive
- Choice of impeller blades
- Swing-open front (std)
- Bolted mounting (std)

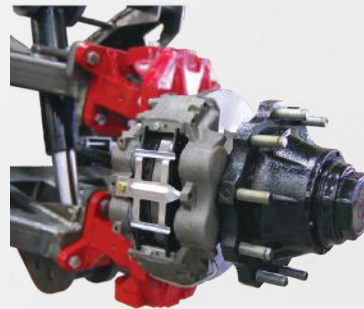

INDUSTRIAL DISC BRAKE SYSTEM

- 4-piston calipers
- 2, 4 or 6 wheel brakes
- Automatic pedal control
- Manual level control
- Dual control
- Air brake option

LOADING OPTIONS

- 40 x 40 hopper 9" or 17" high
- 32 x 32 power-door hopper
- Front & rear fill indicators (std)
- Rooftop pop-up indicator (opt)
- Self-loading kit option

SAFETY EQUIPMENT

- Certified safety chains (std)
- LED signal lights (std)
- Reflective side band decals (std)
- OSHA rated front ladder (std)
- Rooftop safety rail (std)
- Rooftop anti-slip bands (std)
- Night-travel option
 - » Rear-mounted strobes
 - » Rooftop 3-way strobe
 - » DOT striping



Stainless steel fenders



Sand auger system



Level-Lift injector mount

OTHER OPTIONS

- Sand auger system
- Level-Lift parallel arm kit
- Super-Duty Lift kit
- HD injector tow bar (bolt-on)
- Transport tow bar (bolt-on)
- Anti-crash rear bumper

SPECIFICATIONS

	TANDEM / 4-WHEEL				TRIDEM / 6-WHEEL				QUAD / 8-WHEEL		
TANKER DIMENSIONS	4000	4500	5000	5700	5600	6200	6600	7400	8500	9600	10200
TANK LENGTH	16 FT	16 FT	20 FT	20 FT	22 FT	22 FT	26 FT	26 FT	34 FT	34 FT	36 FT
TANK PROFILE	LOW	STD	LOW	STD	LOW	STD	LOW	STD	LOW	STD	STD
US GALLONS	4,000	4,500	5,000	5,700	5,600	6,200	6,600	7,400	8,500	9,600	10,200
IMP GALLONS	3,300	3,800	4,200	4,800	4,600	5,200	5,500	6,200	7,100	8,000	8,500
LITERS	15,100	17,200	18,900	21,500	21,200	23,600	2500	2800	32,200	36,300	38,600
OVERALL LENGTH	23 FT	23 FT	27 FT	27 FT	29 FT	29 FT	33 FT	33 FT	41 FT	41 FT	43 FT
EMPTY WEIGHT (LBS)*	14,000	14,250	15,270	15,550	19,330	19,650	20,890	21,130	27,250	27,720	28,580
APPROX LOADED WT.*	47,000	52,250	57,270	63,350	65,330	71,650	75,900	82,700	88,250	107,550	113,100

*Equipped with 850/50x30.5 tires, other tires may weigh less

TIRE CHOICES

Tankers equipped with super-flotation tires are gentle on roads and fields, and are easier to pull in poor conditions.

TIRE DIMENSIONS	A	B
850/50 x 30.5 Radial	62.5"	34"
850/50 x 30.5 Bias	65"	34"
28L R 26 Radial	62.5"	28"
28L 26 Bias	59"	28"

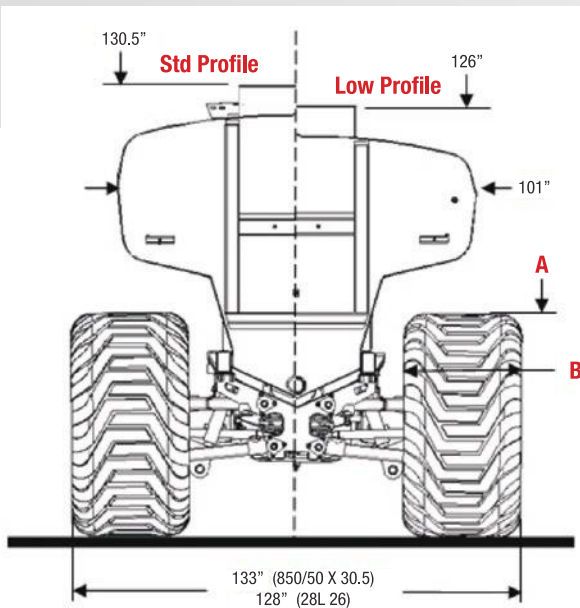

28L R 26 Radial
690 tread



850/50 x 30.5 Bias
648 tread



850/50 x 30.5 Radial
693-M tread

Visit our website for information on all our products.



info@jameswayfarmeq.com

Corporate Office:

12 Route 249
St-Francois-Xavier QC
Canada J0B 2V0

Phone: 819-845-7824
Fax: 819-845-5153

Warehouse:

15383 State Hwy 131,
Tomah, WI 54660
USA

Phone: 608-372-3141
Fax: 608-372-2807